

# SPIDER 65 FPV RACER - USER MANUAL

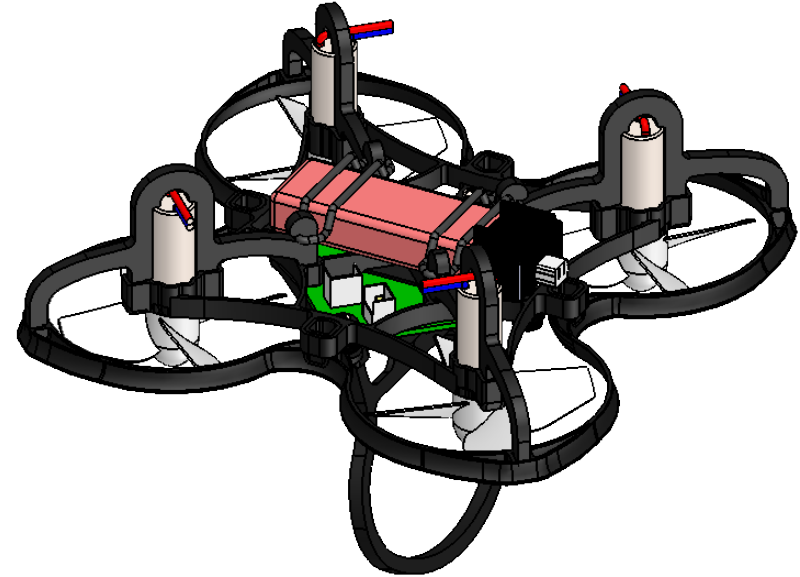
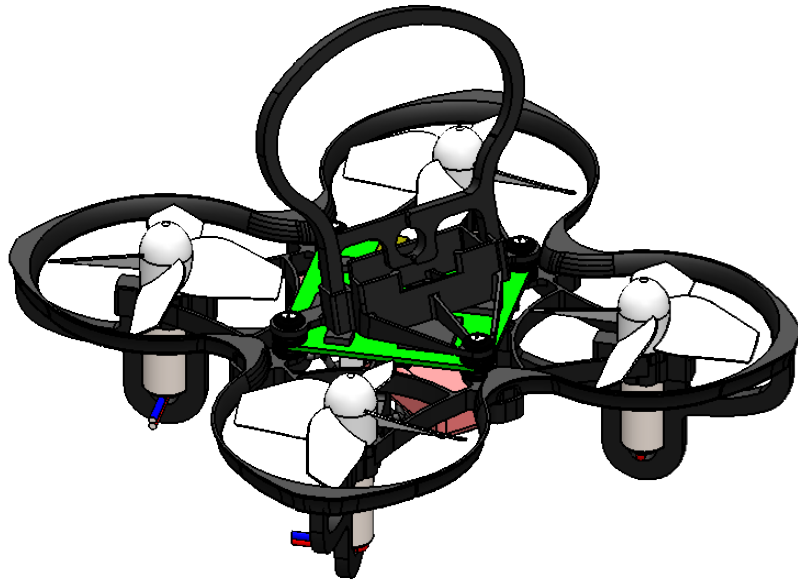

## SPECIFICATIONS:

Weight: Frame: 3.96g, total weight with FPV Camera mount: 4.7g

Materials: Plastic.

Size: 65mm.

Maximum propeller: 31 mm.

Motor mount: 6x15 mm.

Flight controller mount: 29mm x 29mm.

LYNX

# SPIDER 65 FPV RACER - USER MANUAL

## PACKAGE LIST PART

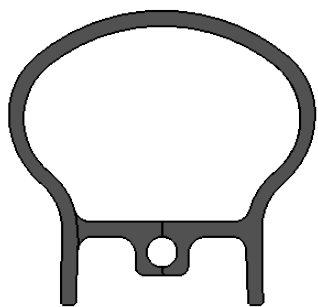

15° FPV Camera Mount PTU-Black

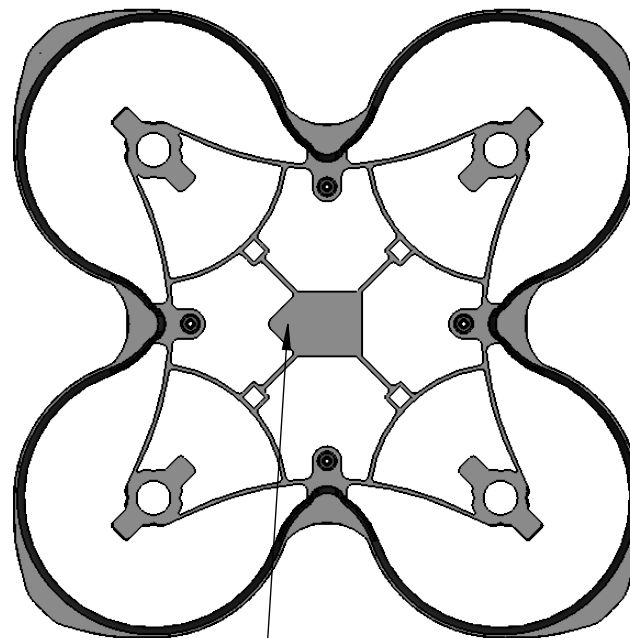
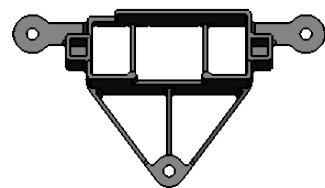

Fly Direction REF

Spider 65-Main Frame Pre-Assembly with Shourd and FC Mount

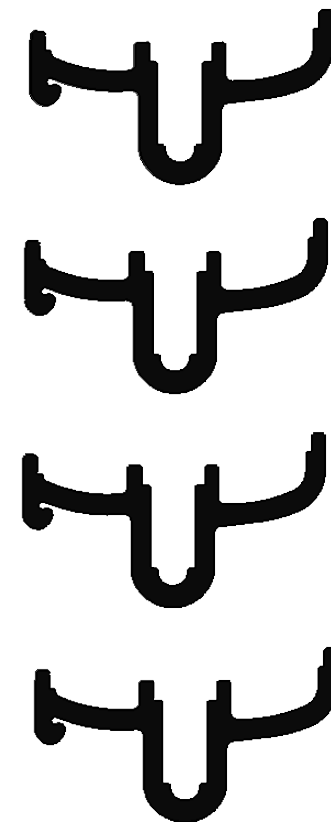

4 x Motor Mount



4 x Washer Ø4xØ1x0.5



4 x M1x3 PANS Head Screw Silver



2 x O-Ring ID 12 - W 1



# SPIDER 65 FPV RACER - USER MANUAL

## Step 01: Motor Assembly

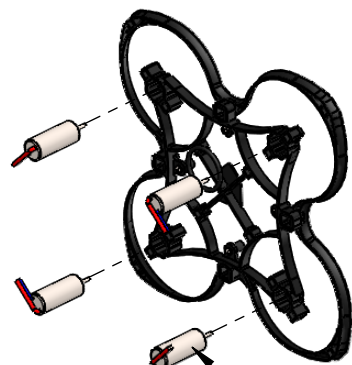

4 x Motor 6x15 mm  
(18500/19000 KV suggest)

Note: Rotate Motor in order Electric Wire will follow the arrow, as shown

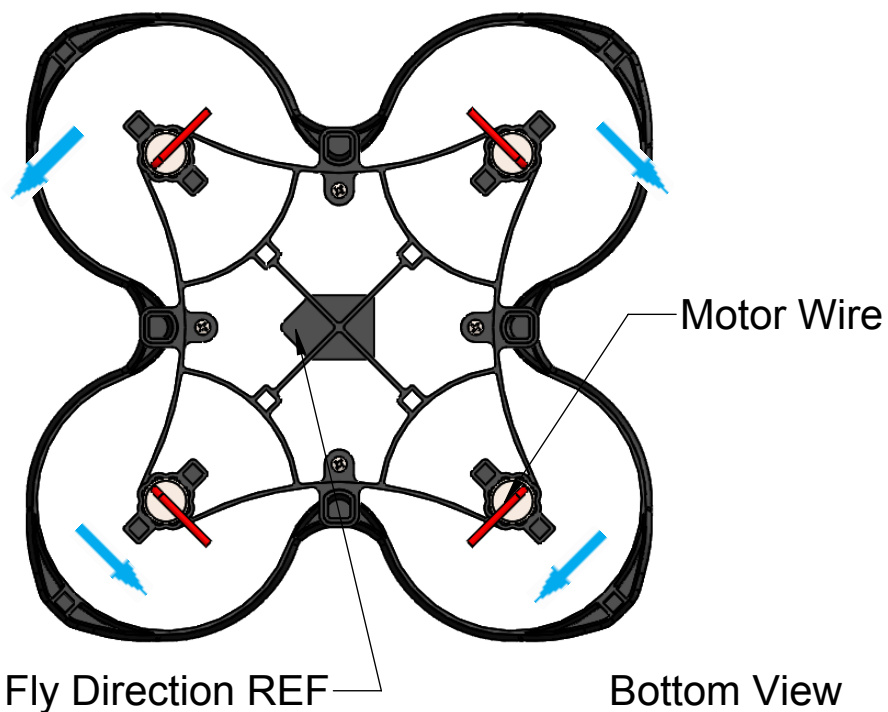

## Step 02: Motor Mount Assembly

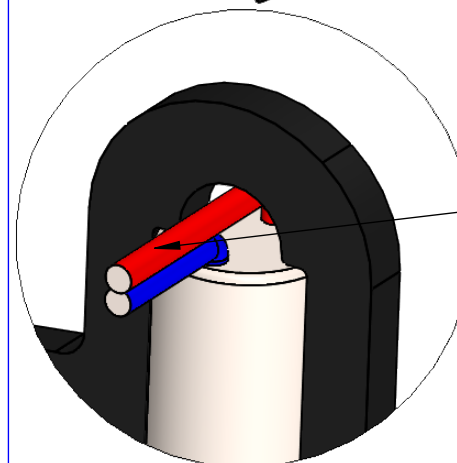
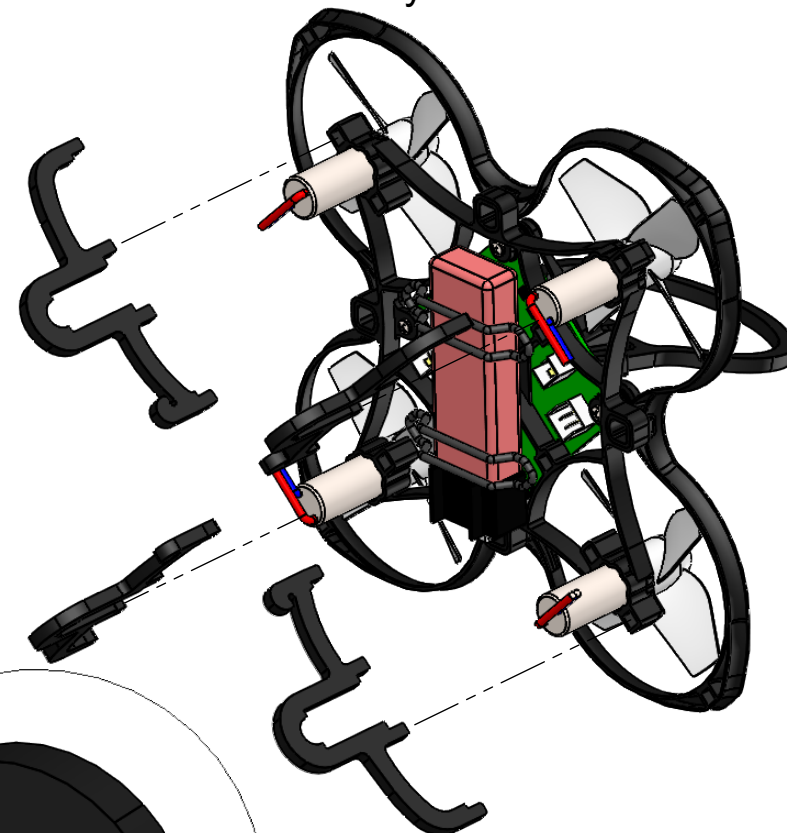

Note 1: Pay attention Motor Wire position to avoid short circuit or pinching

Note 2: Carefully press fit all 16 Motor Mount pins into Frame sockets

LYNX

# SPIDER 65 FPV RACER - USER MANUAL

## Step 03: Flight Control Assembly

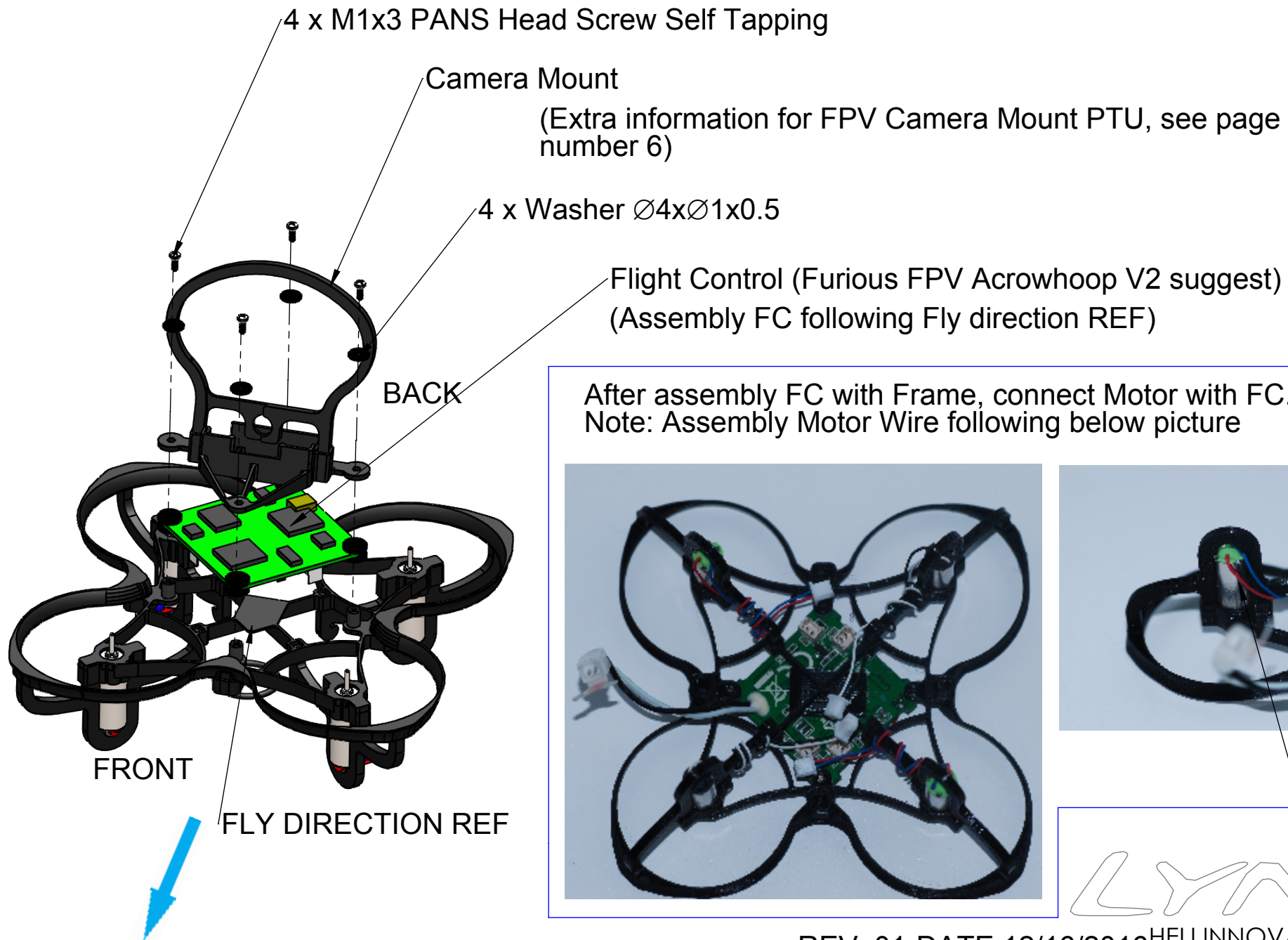

# SPIDER 65 FPV RACER - USER MANUAL

## Step 04: O-Ring Battery Support Assembly

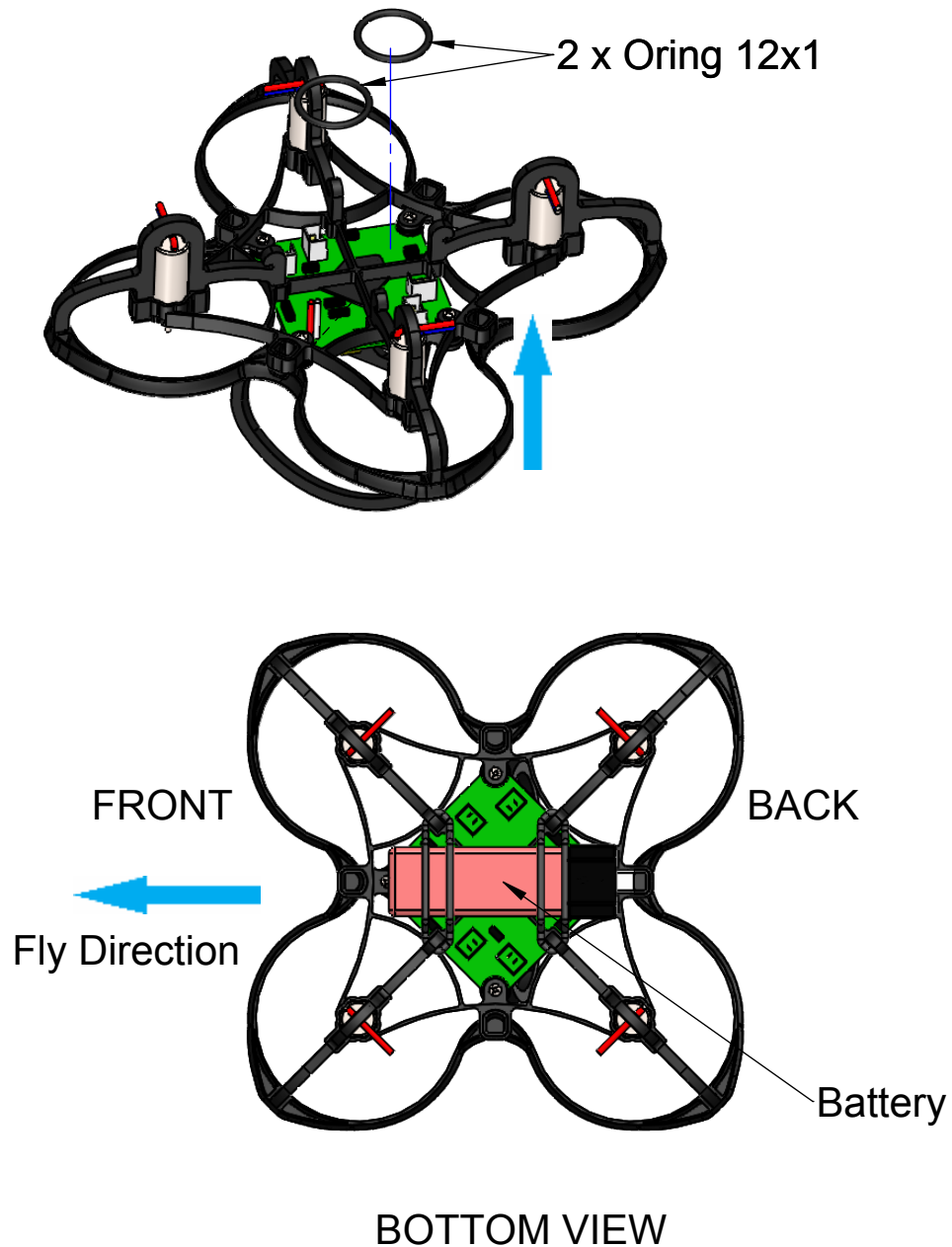

## Step 05: Propeller Assembly

2 x CW propeller

2 x CCW propeller

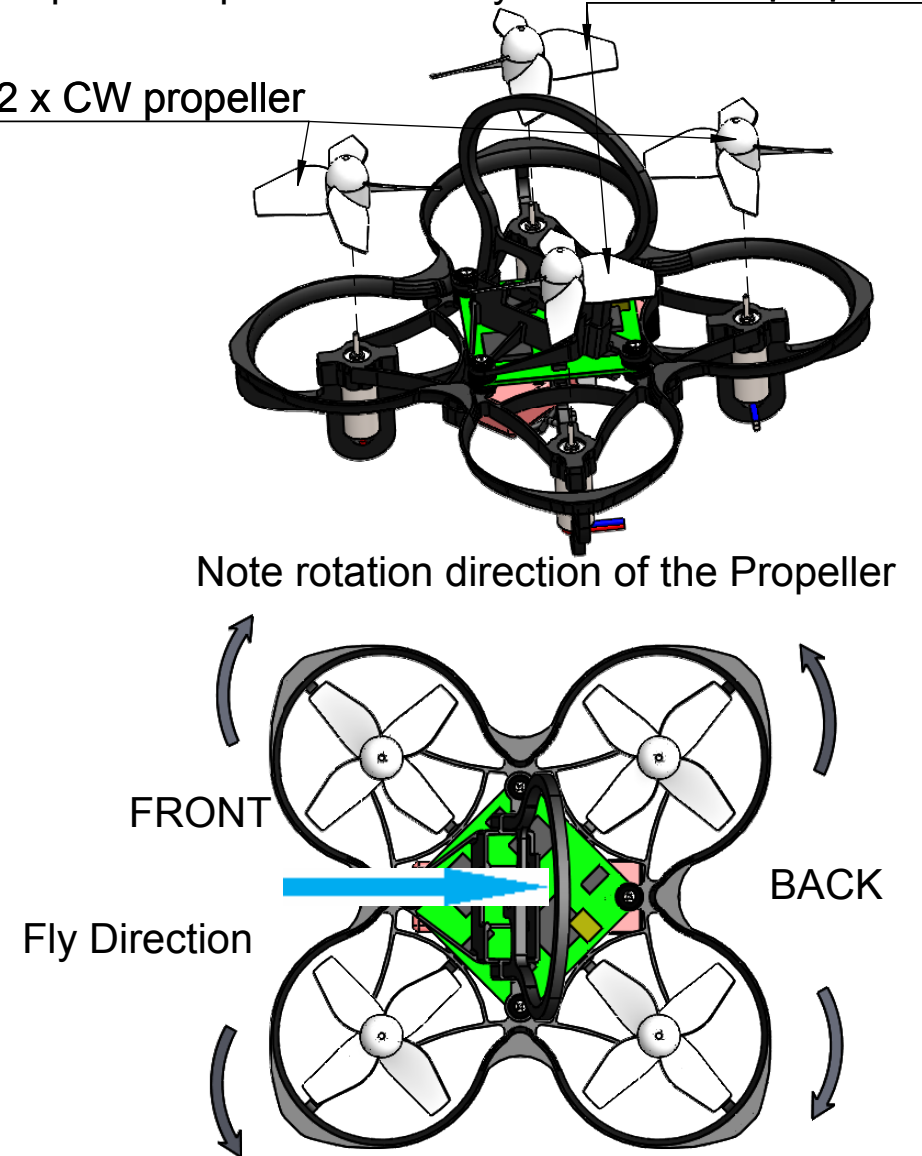

LYNX



## SPIDER 65 - FPV Camera Mount PTU - Manual

Step 01: Insert Camera into Camera Mount

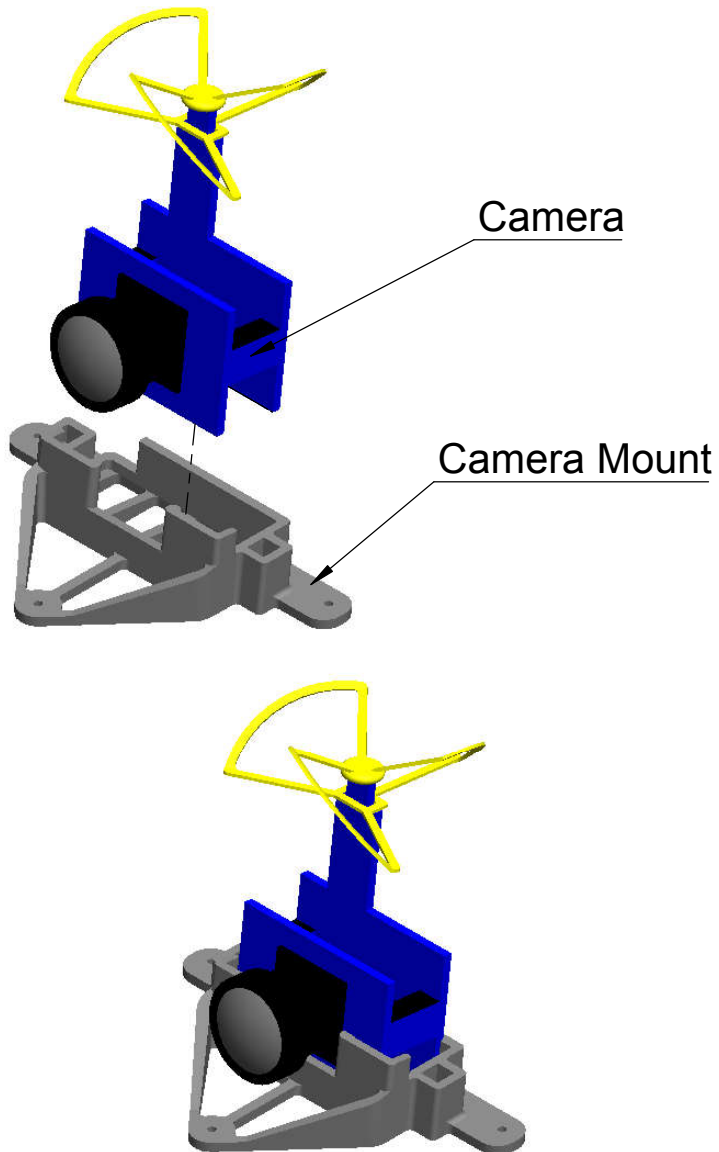

Step 02: Insert Roll Bar into Step 01, press fit Roll Bar into Camera Mount socket (as shown)

