

Step 1

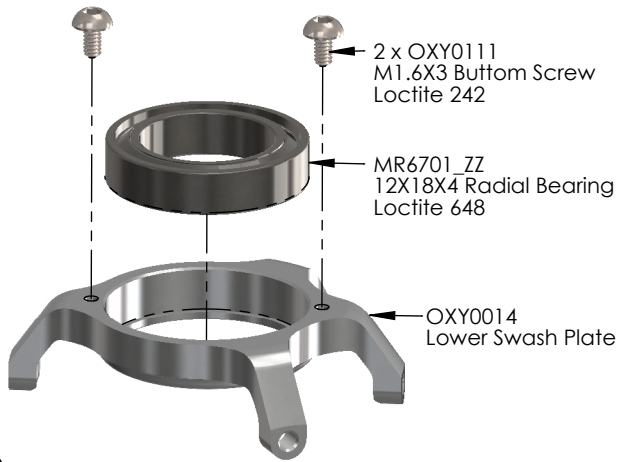

Important Note:
This part, for tuning reasons, comes factory
pre assembled with loctite. It is ready to use.

Step 2

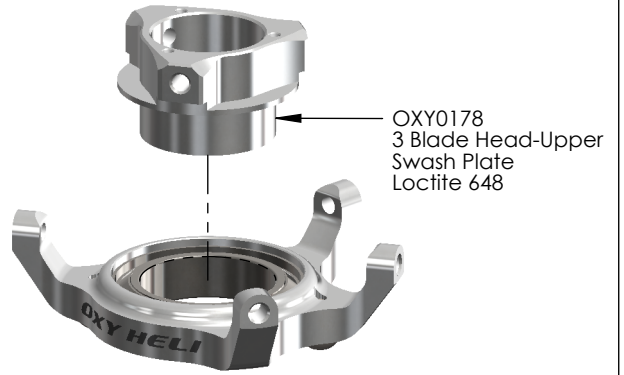

Important Note:
This part, for tuning reasons, comes factory
pre assembled with loctite. It is ready to use.

Step 3



Step 4

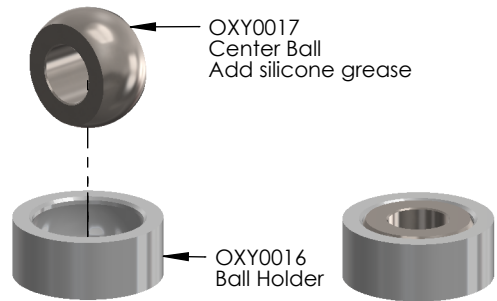

Important Note:
This part, for tuning reasons, comes factory
pre assembled with grease. It is ready to use.

Step 5

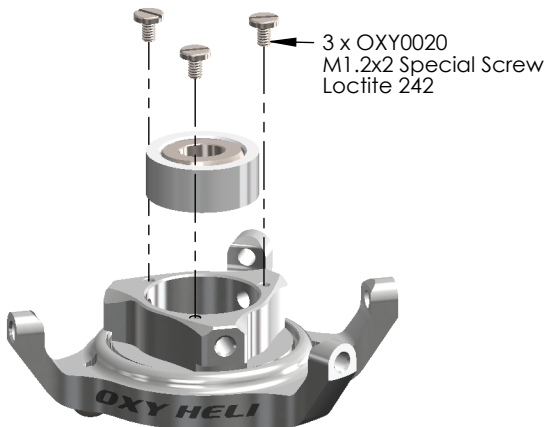

Important Note:
This part, for tuning reasons, comes factory
pre assembled with loctite. It is ready to use.

Step 6

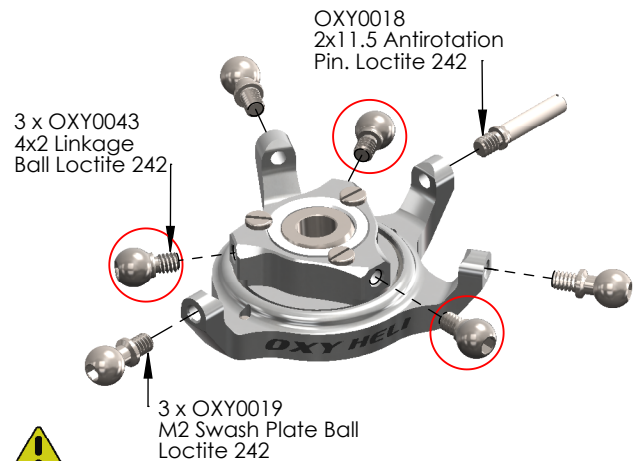

Important Note:
This part comes pre assembled WITHOUT
thread lock. Follow the instruction for final
assembly.

Step 7

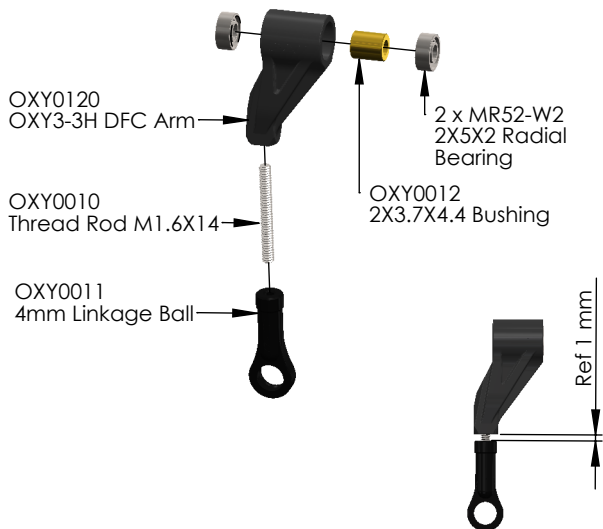

Step 8

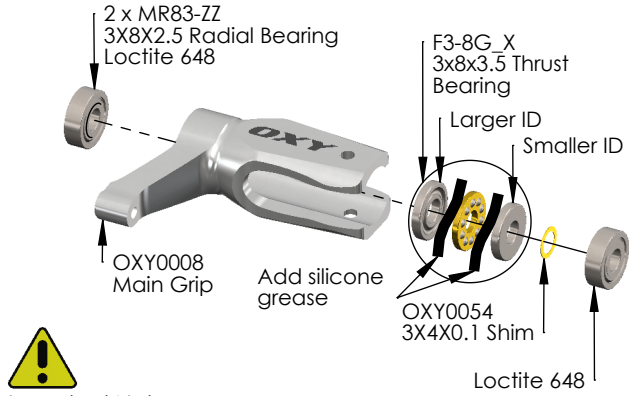

Important Note:
This part, for tuning reasons, comes factory pre assembled with loctite. It is ready to use.

Step 9



Important Note:
This part comes pre assembled WITHOUT thread lock. Follow the instruction for final assembly.

Step 10

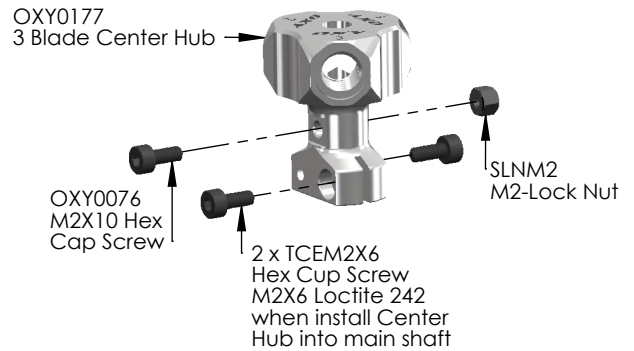

Note: Tighten these two screws (M2x6) with similar torque. Tighten each slowly in turn in a criss-cross manner to similar torque.

Step 11

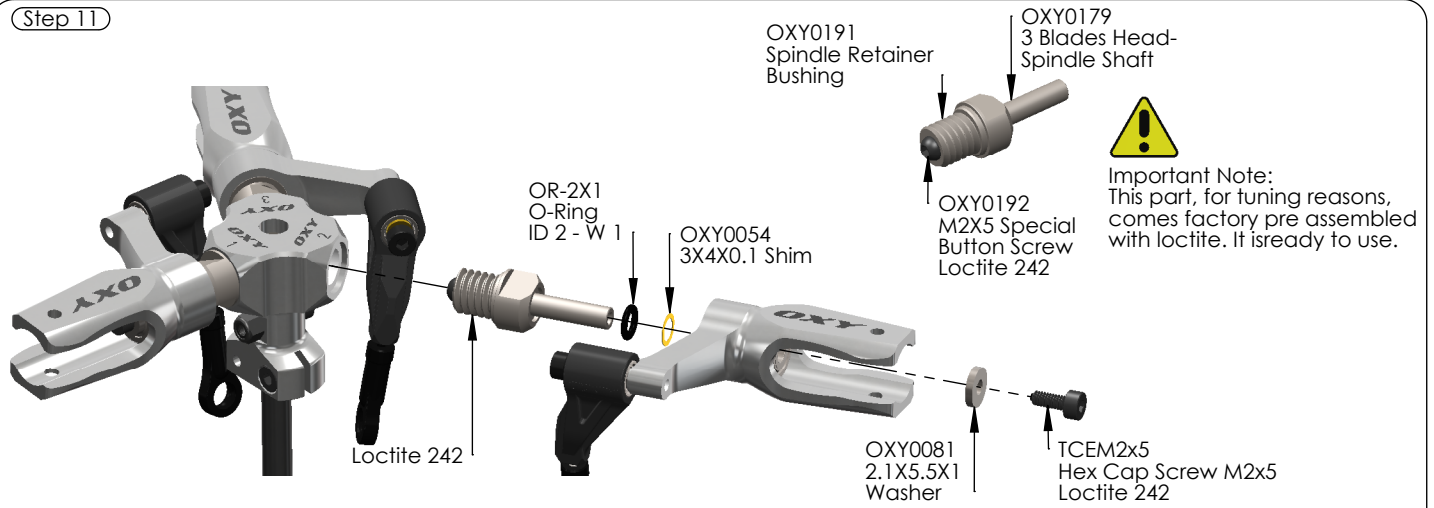

Important Note:
This part, for tuning reasons, comes factory pre assembled with loctite. It is ready to use.

Important Note:
This part comes pre assembled WITHOUT thread lock. Follow the instruction for final assembly.

Step 12



Step 13

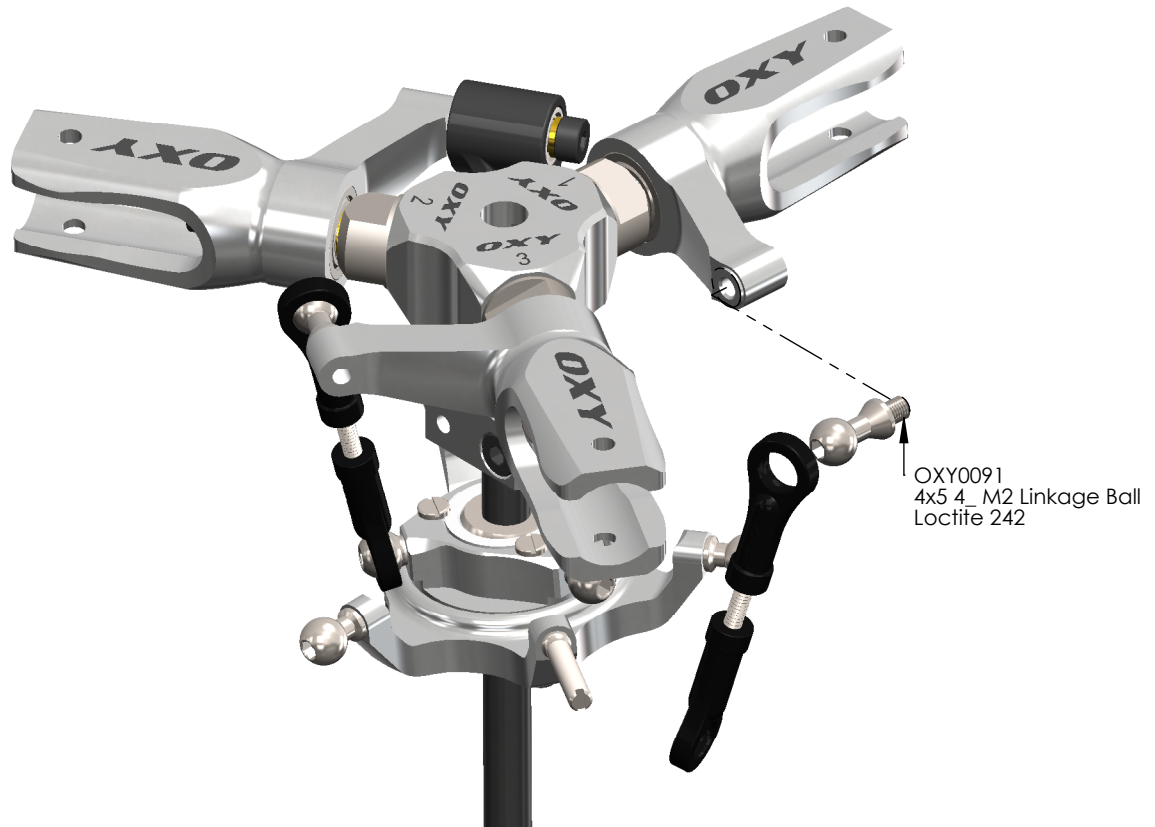

Step 14

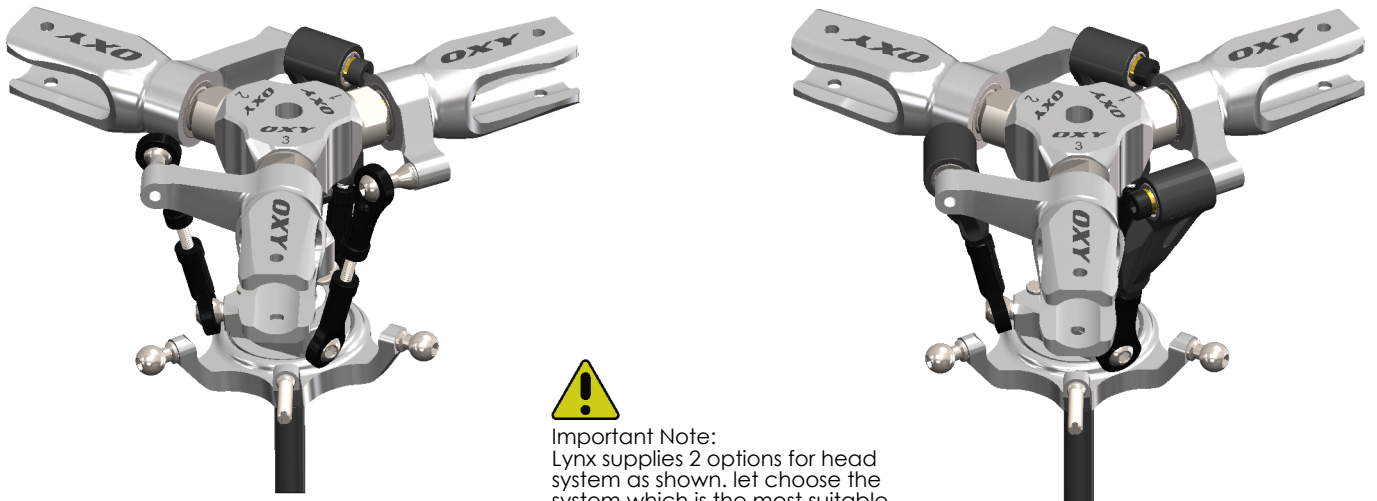

Important Note:
Lynx supplies 2 options for head system as shown. Let choose the system which is the most suitable with your demand.

Step 14

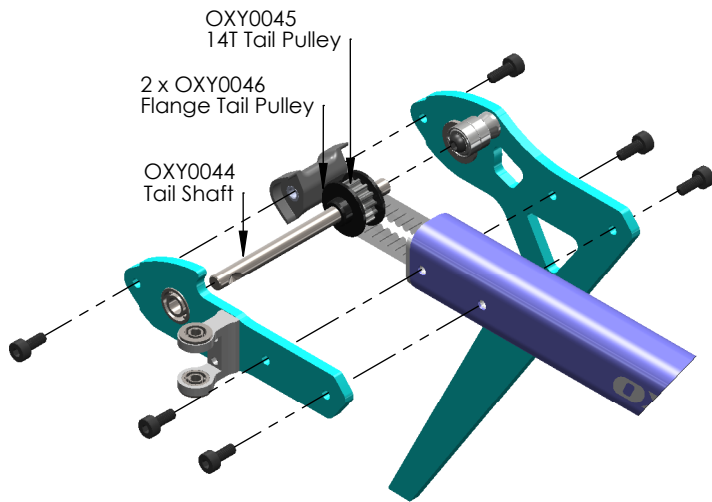

Important note:
14T Pulley - Tail Shaft Assembly ready to use

Step 15

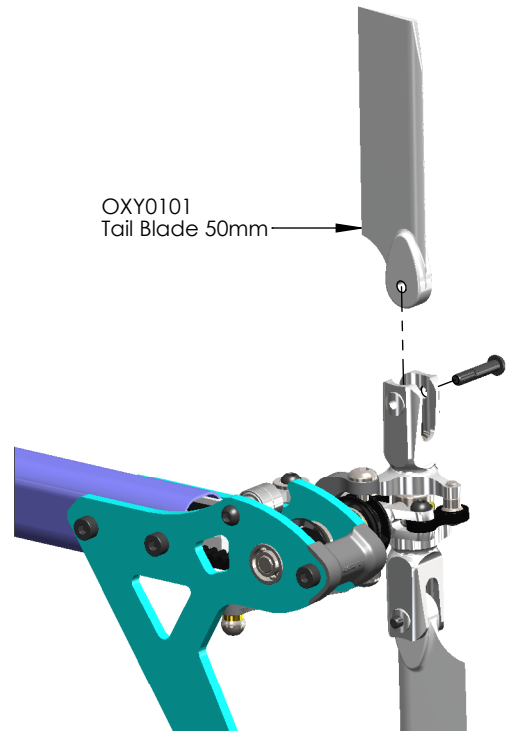

Step 16

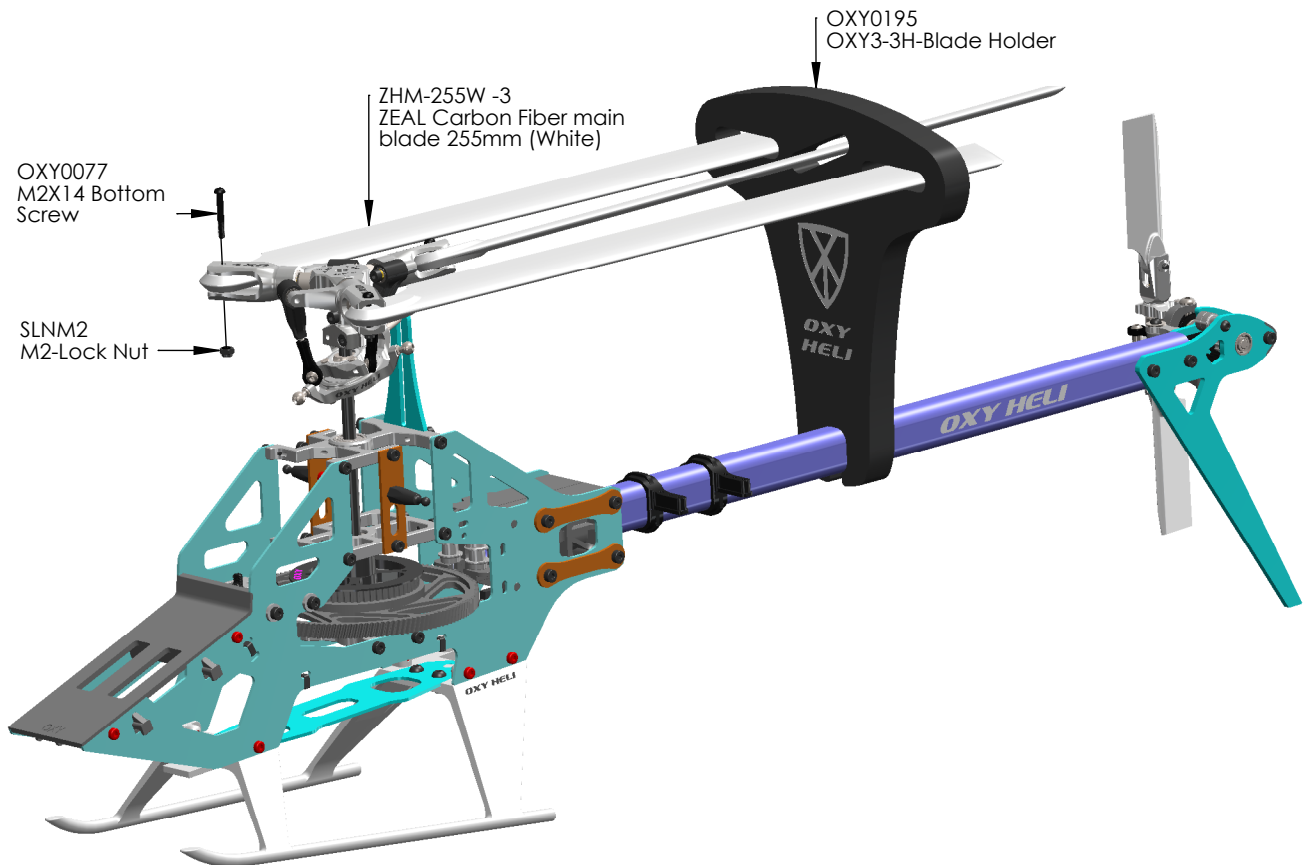

**SP-OXY3-088 OXY3 - QUBE Ultra
Main Grip, 3PCS**



- 3 x Main Grip
- 6 x MR83_ZZ-3x8x2.5 radial bearing
- 3 x 3x8x3.5 Thrust Bearing
- 3 x 3x4x0.1 Shim Washer
- 3 x M2X14 Shoulder Buttom Cap Screw
- 3 x M2-Lock Nut

**SP-OXY3-089 OXY3 -QUBE 3
Blade Center Hub**

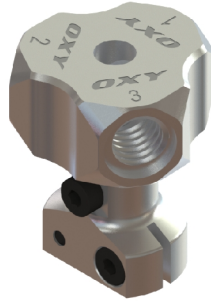

- 1 x 3 Blade Center Hub
- 1 x M2X10 Shoulder Hex Cap Screw
- 1 x M2-Lock Nut
- 2 x M2x6 Hex cup screw

**SP-OXY3-090 OXY3 - QUBE 3
BLADE DFC ARM**



- 3 x OXY3-3H DFC Arm
- 6 x 2X5X2 Radial Bearing
- 5 x Thread Rod M1.6 X 14
- 7 x 4MM Linkage Ball
- 2 x 4x5 4_M2 Linkage Ball
- 3 x DFC Arm Spacer
- 3 x 2x3.5x0.5 Shim Washer
- 3 x M2X14 Shoulder Hex Cap Screw

**SP-OXY3-091 OXY3 -QUBE 3
BLADE Ultra Swashplate**



- 1 x Lower Swash Plate
- 1 x 3 Blade Head-Upper Swash Plate
- 1 x Radial bearing 12x18 H4
- 1 x Ball Holder
- 1 X Center Ball
- 1 x 2x11.5 Antirotation Pin
- 6 X Inner Swash Plate Linkage Ball
- 2 x M1.6X3 Buttom Screw
- 2 x M1.2x2 Special Screw

**SP-OXY3-092 OXY3 -QUBE 3
Blade Spindle Shaft 3PCS**



- 3 x 3 Blade Head-Spindle Shaft
- 3 x Spindle Retainer Bushing
- 3 x M2X5 Special Buttom Screw
- 3 x Hex Cup Screw M2X5
- 3 x 2.1X5.5X1 Washer
- 3 x O-RING ID 2 - W 1
- 3 x 3x4X0,1 Shim

**SP-OXY3-093 OXY3-QUBE
3 Blade Holder**



- 1 x OXY3-3H-Blade Holder 1

**SP-OXY3-094 Double Open-End
Wrench 5.5 x 7mm**

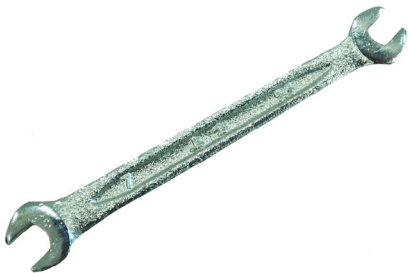

- 1 x Double Open-End Wrench 5.5 x 7mm

**ZHM-255W -3 ZEAL Carbon Fiber
main blade 255mm (White)**



- 3 x ZEAL Carbon Fiber main blade 255mm (White)