

**LX1786 LYNX SPORT BELT CONVERSION****STEP 1 (x2)**

This part comes pre assembled.  
it is ready to use

**STEP 2****STEP 3****PACKING VIEW****STEP 4**

**NOTE:** Before installation you have to  
remove bearing inside the front gear case  
and tail gear case

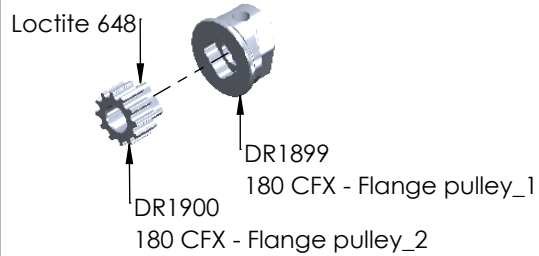
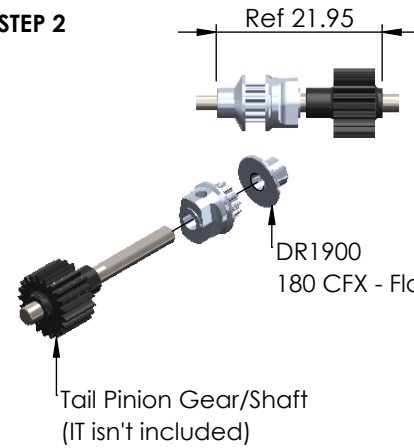
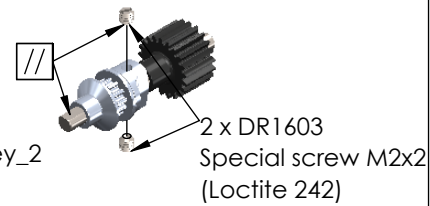
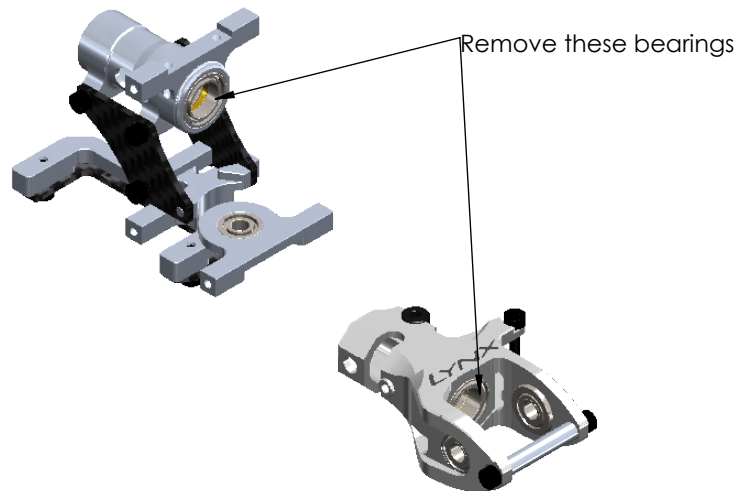

**TIP:** To remove bearing inside  
aluminum parts you should  
make it hot before. Loctite will  
be melted then you can take  
bearing out easily

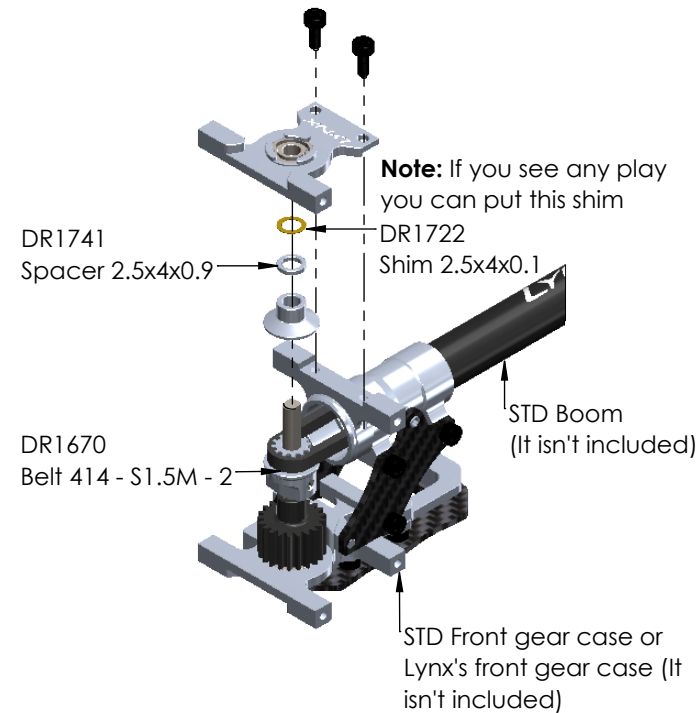
**STEP 5**

## LX1786 LYNX SPORT BELT CONVERSION

## STEP 6

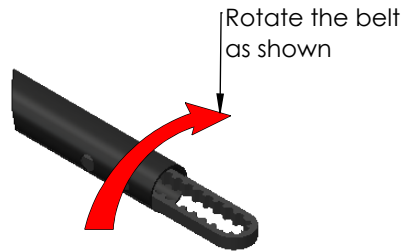

**Note:** Be careful to check the belt is not twisted inside the boom. Use a light to check inside the boom

## STEP 7

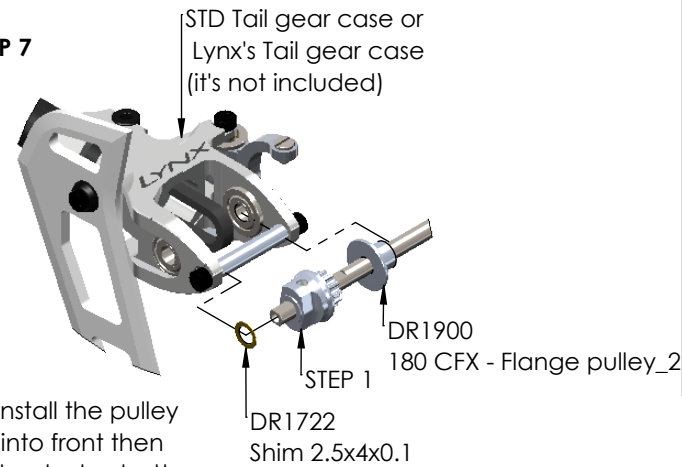

**Note:** To be easily install the pulley you pull the Boom into front then install pulley and check play between 2 bearings. If you can see any play you can put this Shim.

## PACKING VIEW



## STEP 8

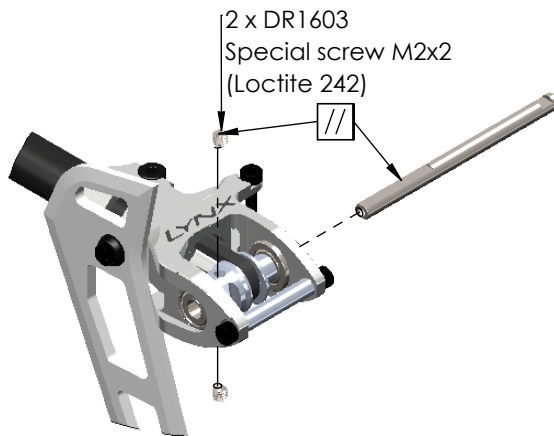

## STEP 9

**Note:** To adjust the belt tension by pulling the boom. The belt should not be over tight. A good load pull is around 1 kg ( 2.2 ps).  
Recheck belt tension after fist fly

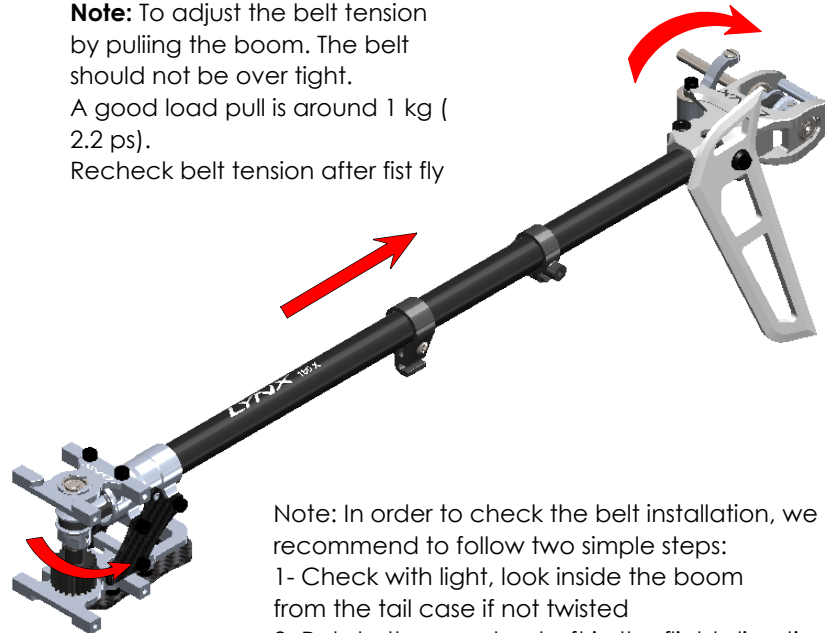

**Note:** In order to check the belt installation, we recommend to follow two simple steps:  
1- Check with light, look inside the boom from the tail case if not twisted  
2- Rotate the counter shaft in the flight direction (as shown) and check the tail shaft rotates in the direction shown. If the Tail shaft rotates in the wrong direction, go back to the previous instructions and double check your work