

LX1687 - 180 CFX - Lynx Pro Edition Belt Conversion - Combo

180 CFX - FRONT BOOM MOUNT_BELT



180 CFX- TAIL CASE_BELT



180 CFX - COUNTER SHAFT_BELT

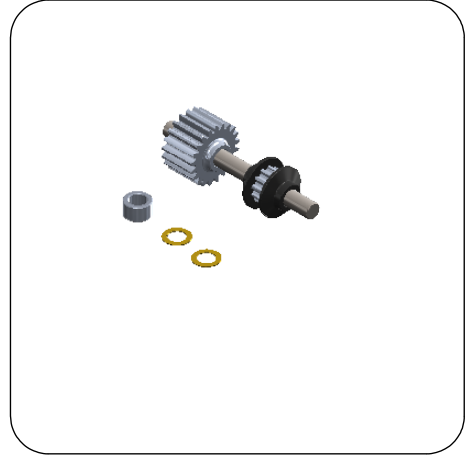

180 CFX - TAIL SHAFT_BELT

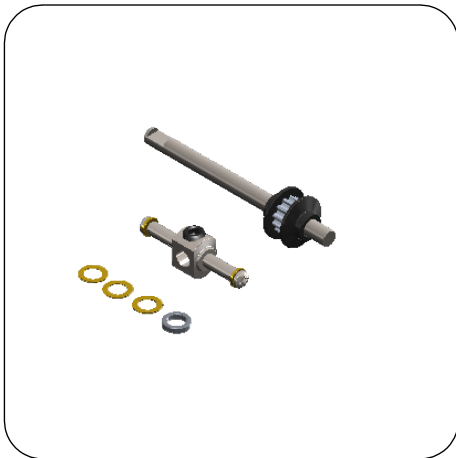

180 CFX - TAIL PUSH ROD_BELT

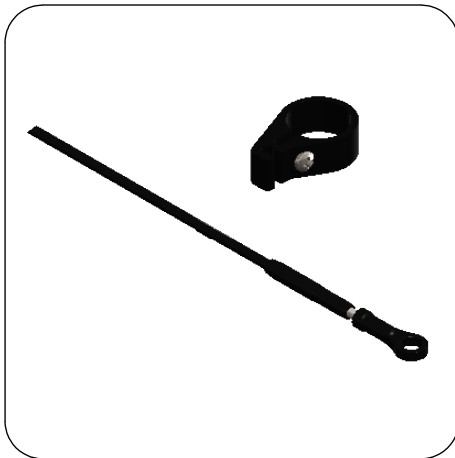

180 CFX - TAIL BOOM

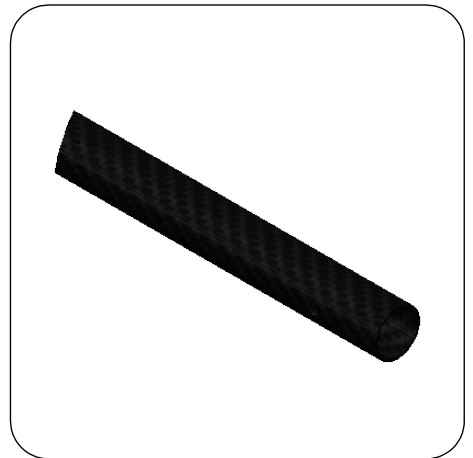

180 CFX - TAIL SERVO MOUNT & 180 CFX - TAIL BOOM SUPPORT

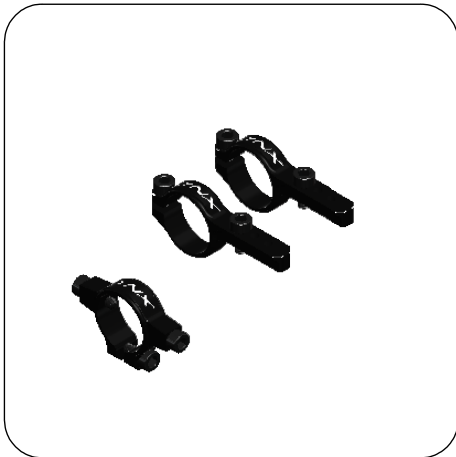

180 CFX - BELT



LX1687 - 180 CFX - Lynx Pro Edition Belt Conversion - Combo

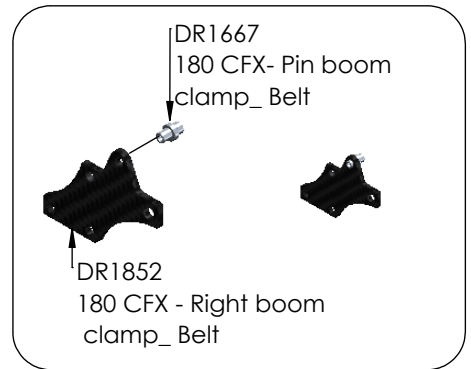
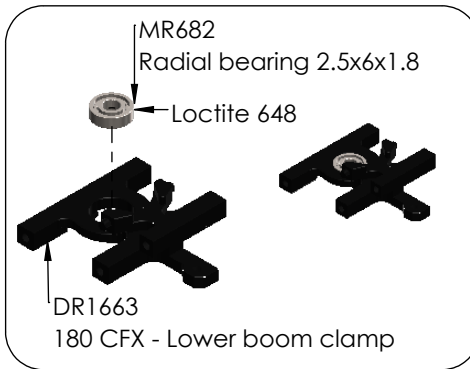
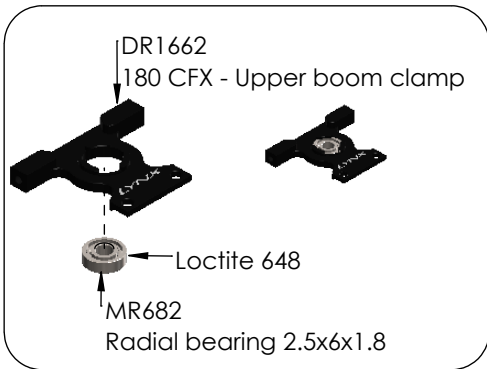

STEP 1

DR1818
180 CFX - Main boom clamp_Belt

DR1819
180 CFX - Left boom clamp_Belt

THIS STEP ASSEMBLY IN FACTORY WITH LOCTITE. IT'S READY TO USE

TCEM2X8
Hex cup screw M2x8

Note: Put Loctite 242 and full tighten after install the Boom

2 x TCEM1.6X5
Hex cup screw M1.6x5

Loctite 242 after install the servo

5 x TCEM1.6X4
Hex cup screw M1.6x4
Loctite 242

DR1664
180 CFX - STD Tail servo support

2 x TCEM1.6X4
Hex cup screw M1.6x4
Loctite 242

DR1769
180 CFX - Sub tail servo case stiffener



STEP 2

Note: Add more shim if you see any play

2 x TCEM1.6X4
Hex cup screw M1.6x4
Loctite 242

DR1722
Shim 2.5x4x0.1

DR1731
Spacer 2.5x4x2.5

DR1670
Belt 414 - S1.5M - 2

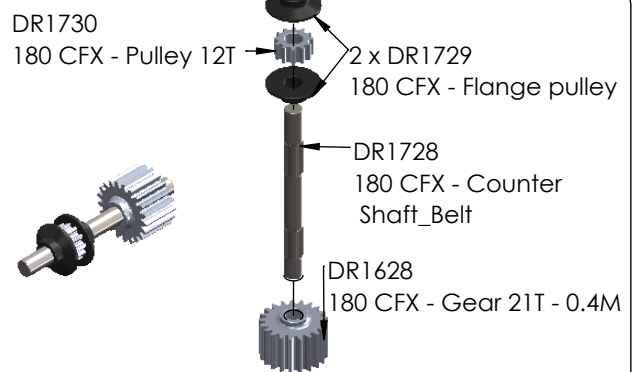
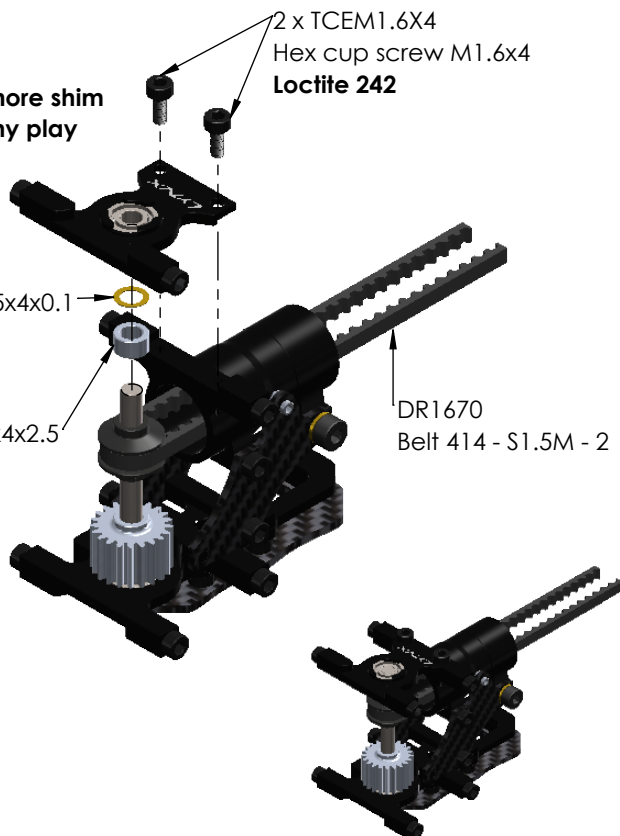

Note: This part comes pre assembled. it is ready to use

LX1687 - 180 CFX - Lynx Pro Edition Belt Conversion - Combo

STEP 3

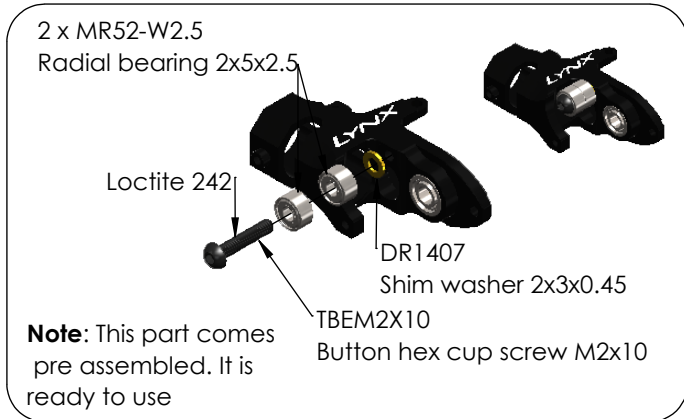
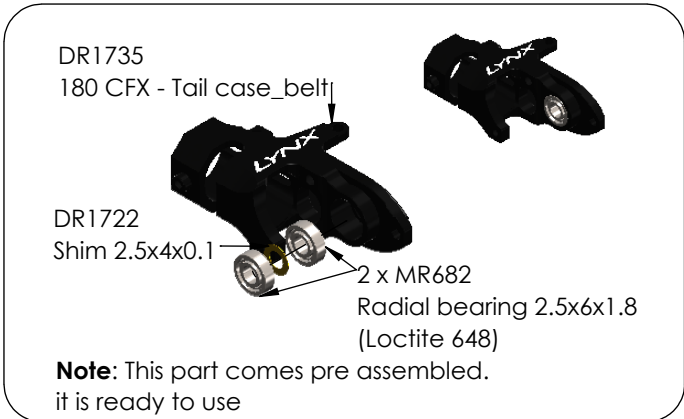
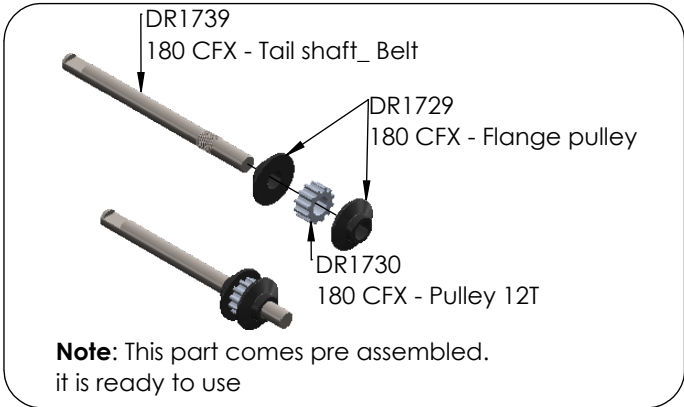
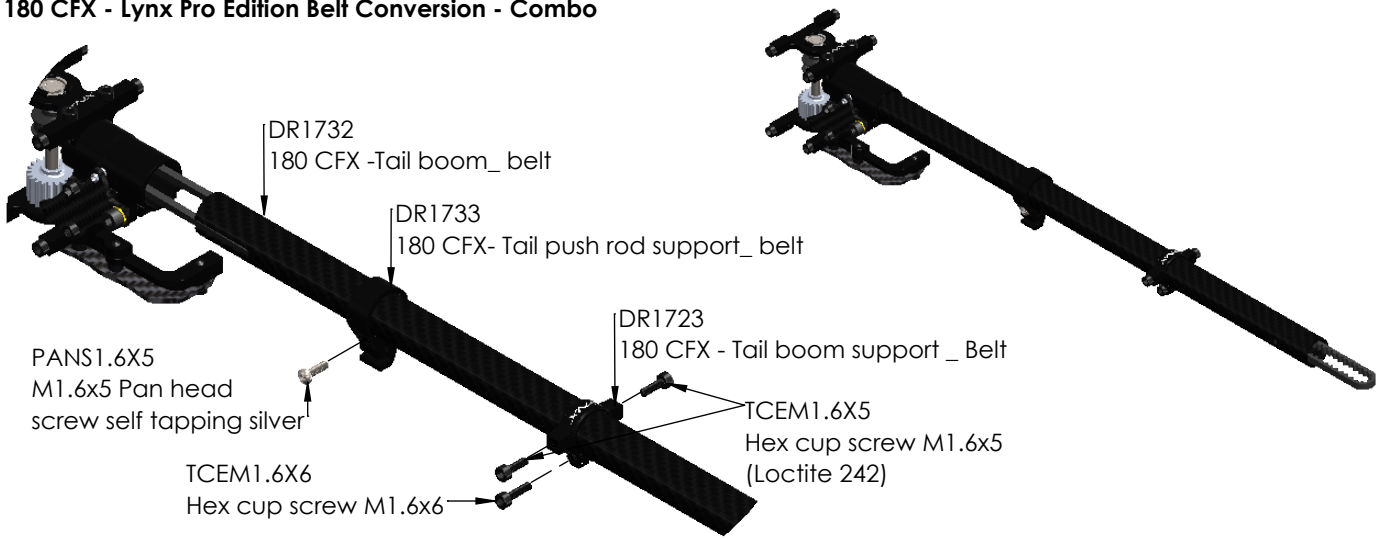

STEP 4

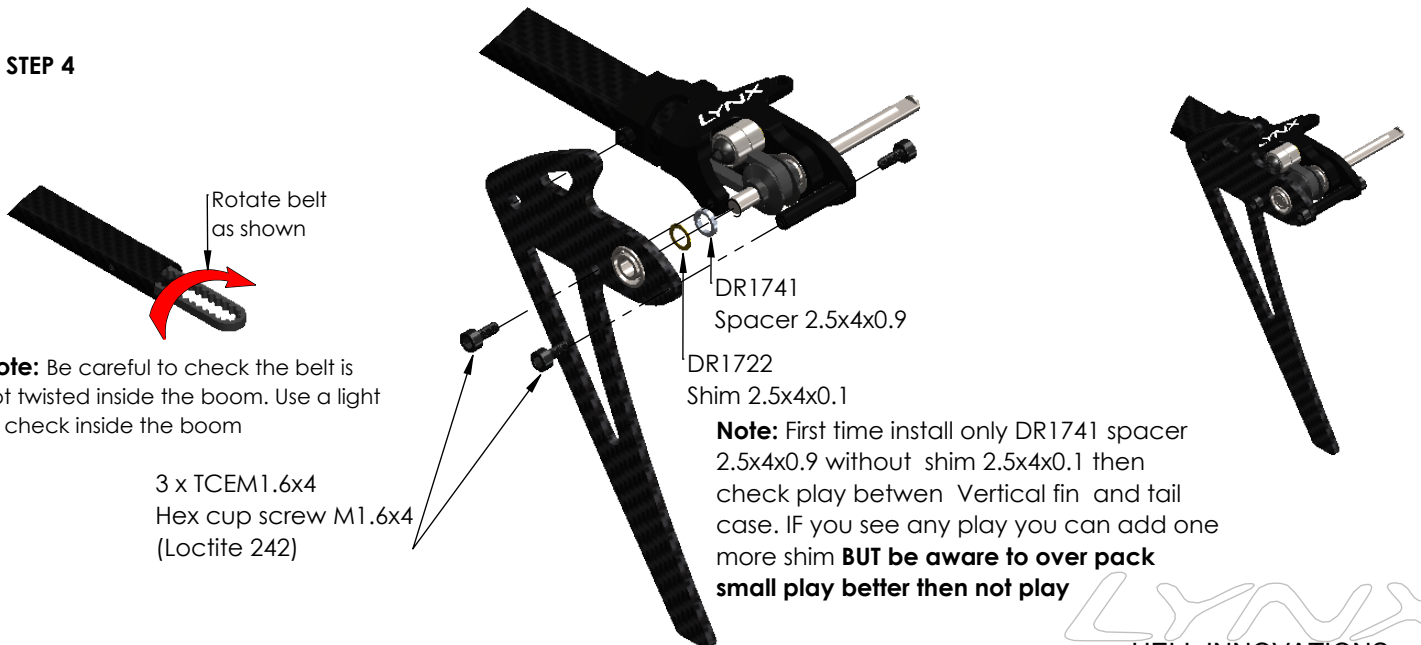

LX1687 - 180 CFX - Lynx Pro Edition Belt Conversion - Combo

STEP 5

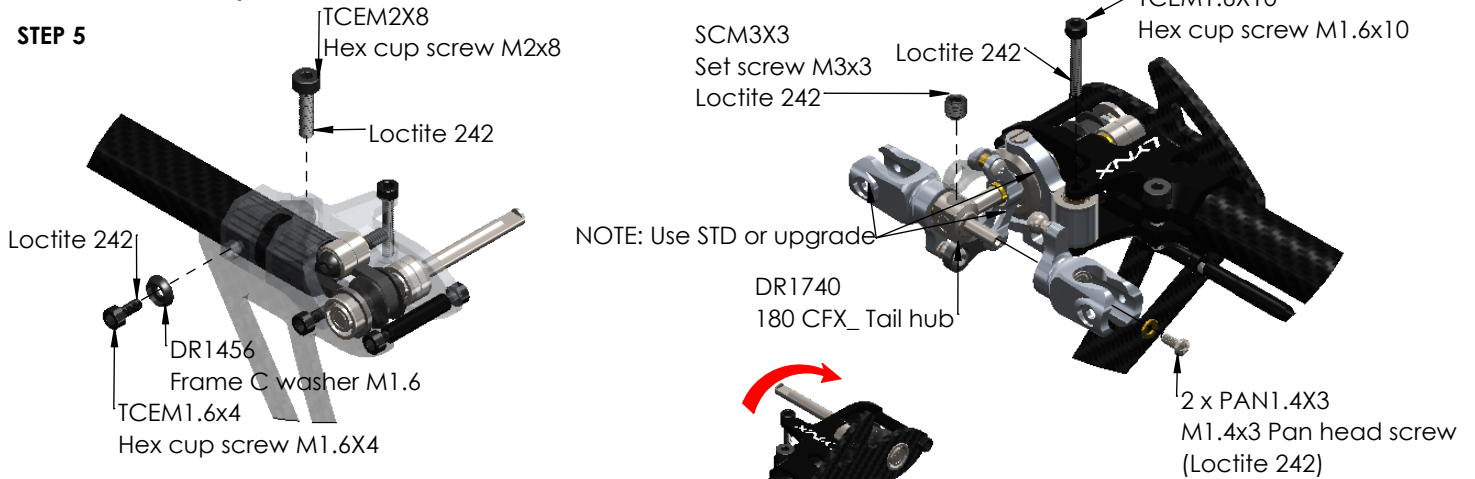

NOTE: Use STD or upgrade

Note: To adjust the belt tension by pulling the boom. The belt should not be over tight. A good load pull is around 1 kg (2.2 ps).
Recheck belt tension after fist fly.

Note: In order to check the belt installation, we recommend to follow two simple steps:
1- Check with light, look inside the boom from the tail case if not twisted
2- Rotate the counter shaft in the flight direction (as shown) and check the tail shaft rotates in the direction shown. If the Tail shaft rotates in the wrong direction, go back to the previous instructions and double check your work.

STEP 6

In order to give tail servo position, tail push rod supply is not assembled. flollow step in function for your need

6.1 STD tail servo position

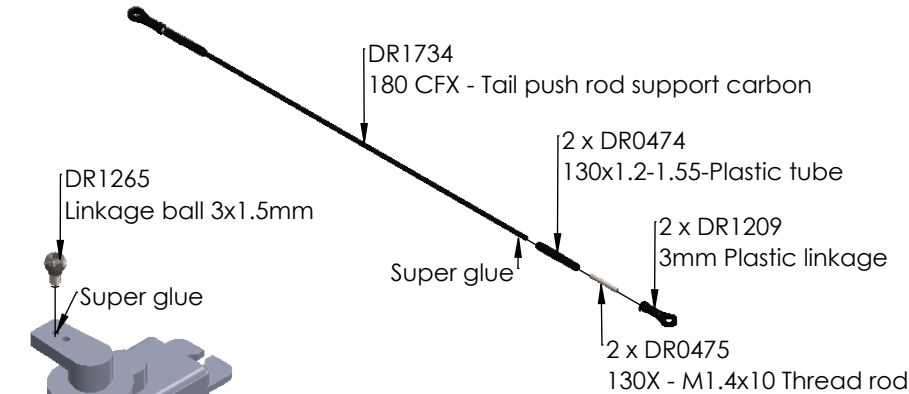
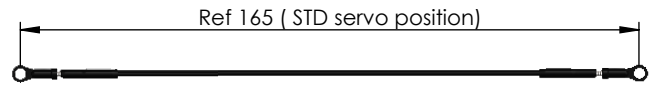

6.2 Tail boom servo position

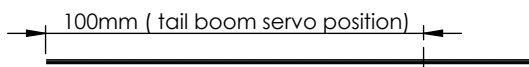

Cut **DR1734 - 180 CFX - Tail push rod support carbon** as the dimension shown then assemble like step 6.1

