

LX1668 GOBLIN 380 - ULTRA SWASH PLATE - SILVER
 LX1669 GOBLIN 380 - ULTRA SWASH PLATE - RED
 LX1670 GOBLIN 380 - ULTRA SWASH PLATE - BLACK
 STEP 1

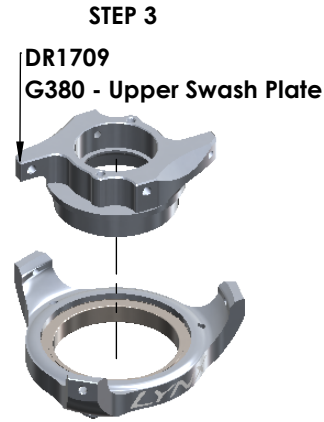

Assembly view

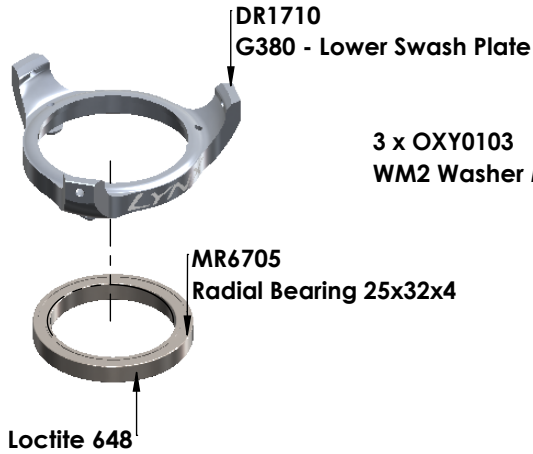
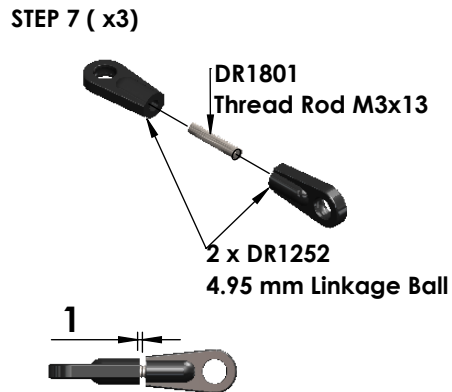
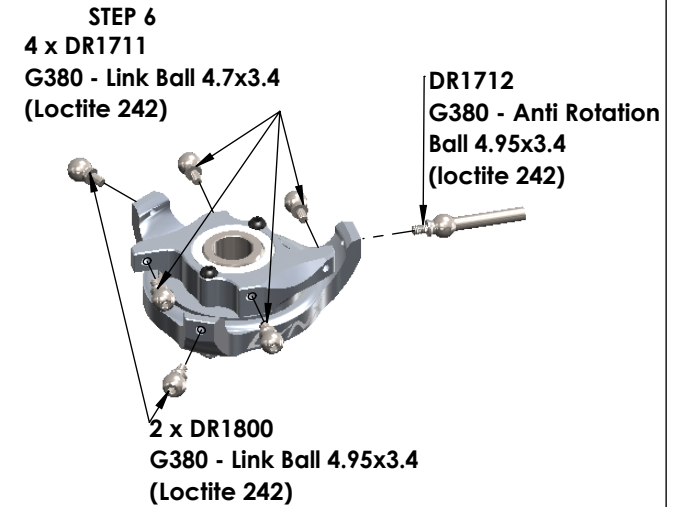
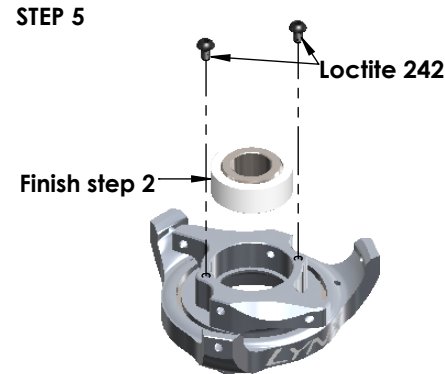
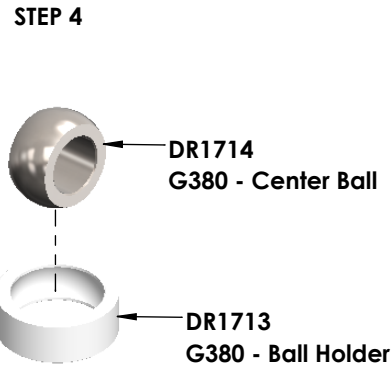
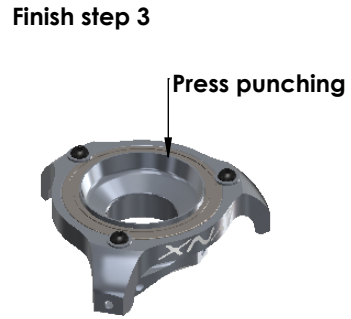

Note: Put super glue when you use plastic servo arm

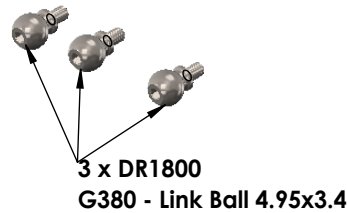

Note: Change 3 STD Servo rods, STD antirotation guide and 3 Uniballs M2(H0538-S) by Lynx's part

LX1668 GOBLIN 380 - ULTRA SWASH PLATE - SILVER
 LX1669 GOBLIN 380 - ULTRA SWASH PLATE - RED
 LX1670 GOBLIN 380 - ULTRA SWASH PLATE - BLACK

Additional option for who want to use the STD SAB ball and linkage

STEP 7.1

Cut 3 pairs of SAB's linkage with the dimension as shown

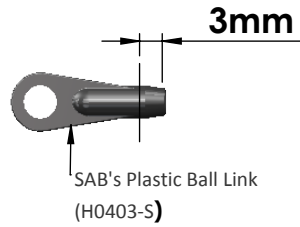

After cut

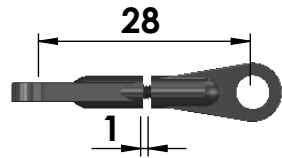
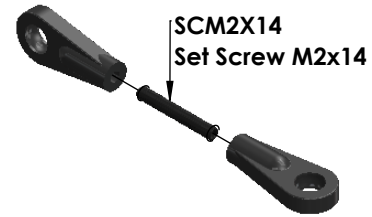

Note: Set lenght like shown

Assembly view



STEP 8

