

LX1449 180 CFX - Ultra Dampeners

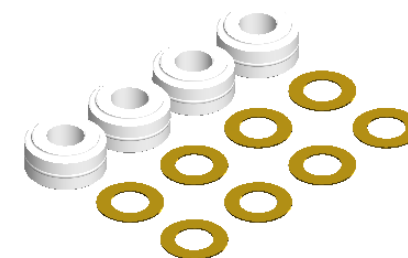
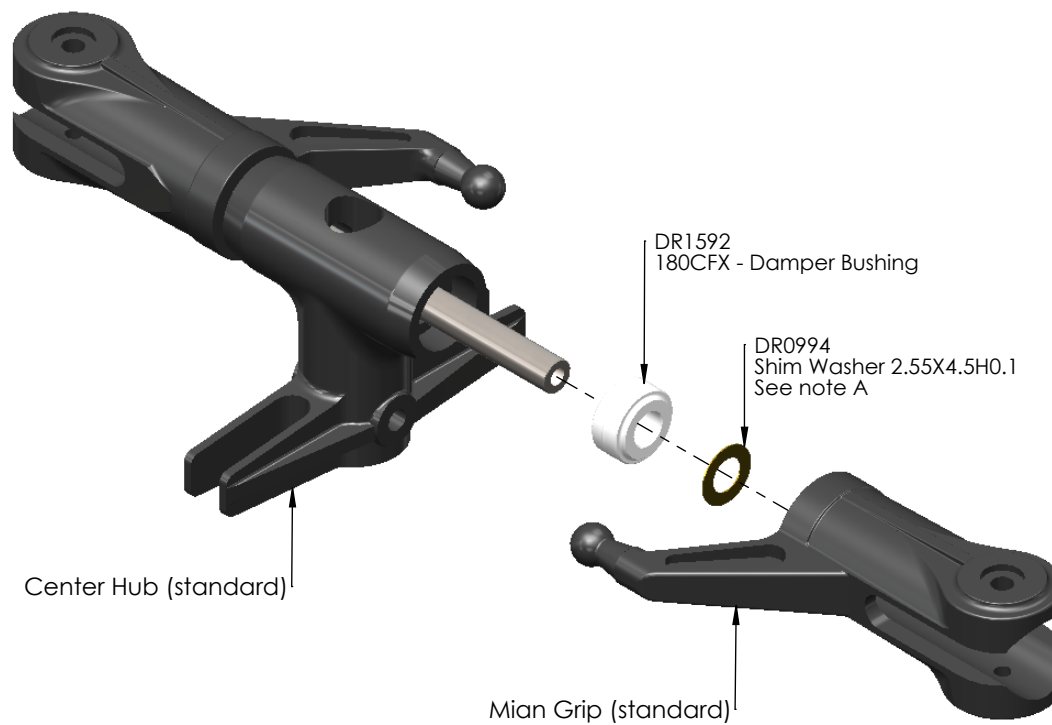

Assembly note

Note A

- In LX1449 Ultra Dampeners bag, you will see 8 shims 2.55x4.5xH0.1
- First time install only Damper Bushing not shim 2.55x4.5xH0.1, check play between center hub and main grip. If you see any play, you can install one shim per side.
- Lynx suggest installing shim the same number per side until removing any play between center hub and main grip.