

LX1438 180 CFX - ULTRA MAIN GRIP SET - SILVER  
 LX1439 180 CFX - ULTRA MAIN GRIP SET - RED  
 LX1440 180 CFX - ULTRA MAIN GRIP SET - BLACK

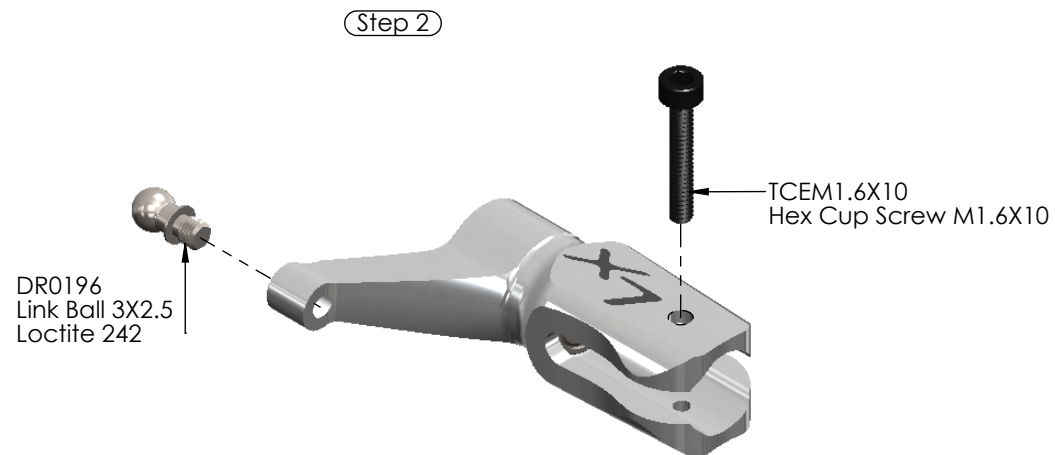

## Assembly finish

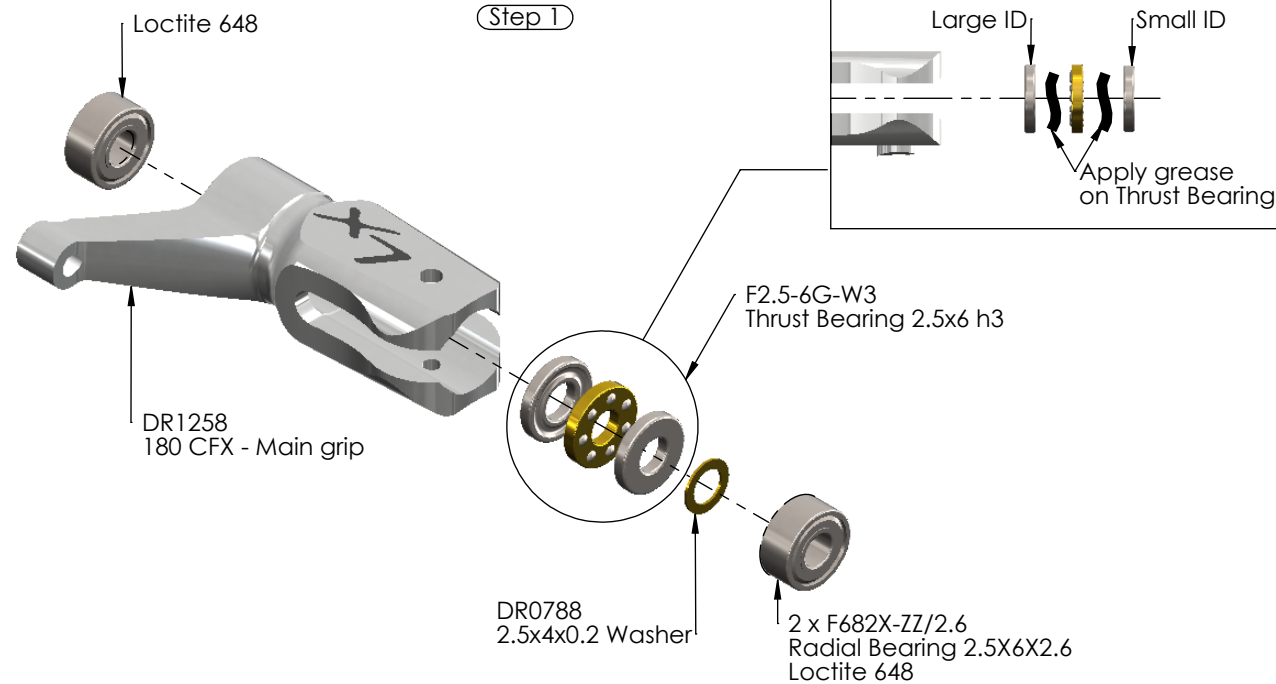
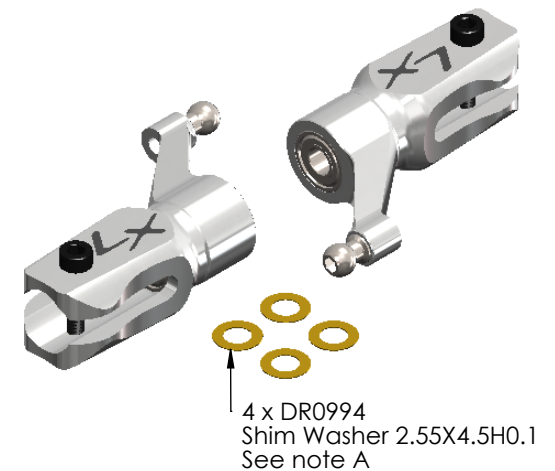

## Assembly note

when install Lynx's main grip into center hub, if you see any play between them. Let use these shims to remove any play  
 Install the same quantity in left and right to remove any side way play.  
 Lynx suggest to start with 2 shims per side and check the assembly, or in case with 2 shims per side you feel the assembly notch, remove one shims per side and try with one per side.